

Set up a Pop3/IMAP email account manually MXA

Android on Galaxy S4 also supports general email accounts such as those using POP (Post Office Protocol), IMAP (Internet Message Access Protocol) or ActiveSync technology.

Let's say if you have an office email account that is using either one of the above technologies, you can set it up using the pre-loaded **Email app**. Here's how:

1. Launch the **Email app** on your phone. *Note: Skip to **step 4** if you haven't setup any email account on the Email app.*
2. Tap the **Menu** button, and then select **Settings**.

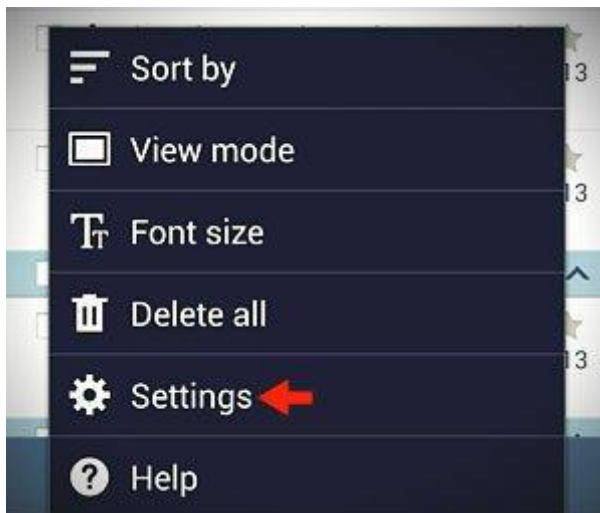

3. On the **Settings** screen, tap **Add account**.



4. Enter the email account and password and tap **Manual setup**.
*Note: Tapping **Next** would instruct Galaxy S4 to automatically configure your email account*



5. Next, select the type of email account. For this tutorial, I will select POP3 account.

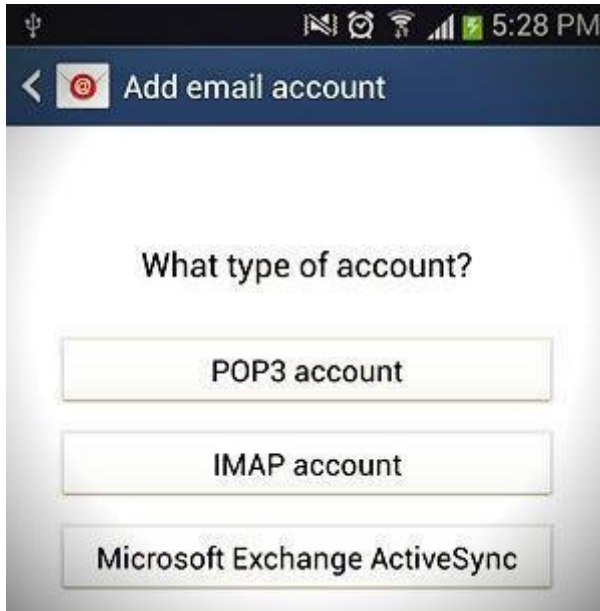

6. Fill in the incoming server settings and tap **Next**. If you don't have such information, do ask from your service provider.

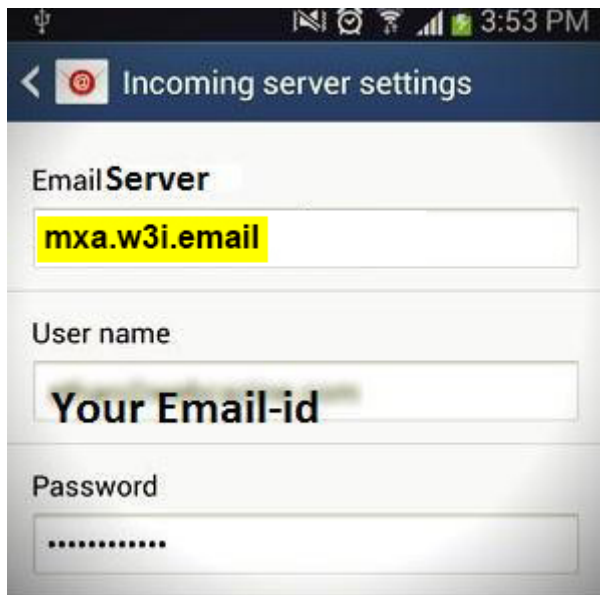

The screenshot shows the 'Incoming server settings' screen. The 'Email Server' field is filled with 'mx.w3i.email'. The 'User name' field is filled with 'Your Email-id'. The 'Password' field is filled with a series of dots. The time is 3:53 PM.

7. Fill in the outgoing server settings and tap **Next**. If you don't have such information, do ask from your service provider.

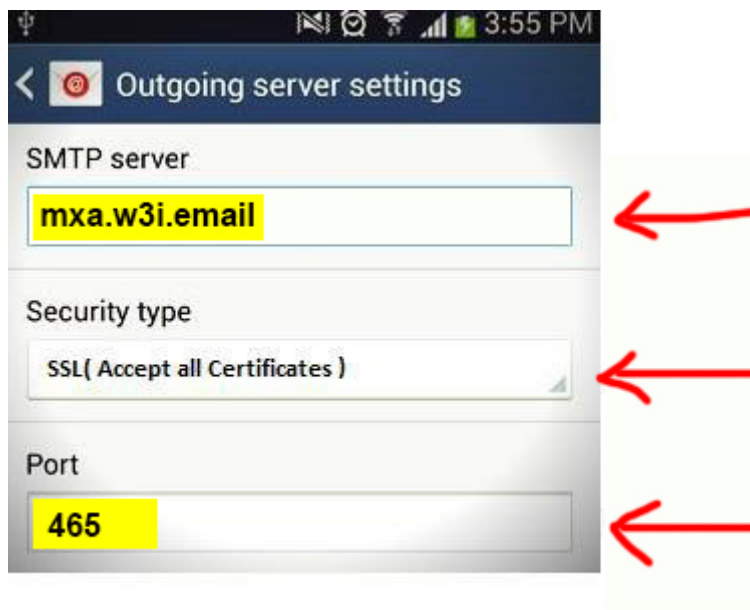

The screenshot shows the 'Outgoing server settings' screen. The 'SMTP server' field is filled with 'mx.w3i.email'. The 'Security type' dropdown is set to 'SSL(Accept all Certificates)'. The 'Port' field is filled with '465'. Three red arrows point to the 'SMTP server', 'Security type', and 'Port' fields. The time is 3:55 PM.

8. On the **Account options** screen, customize the email syncing frequency for both peak and normal hours, tick both **Sync Email** and **Notify me when email arrives**.

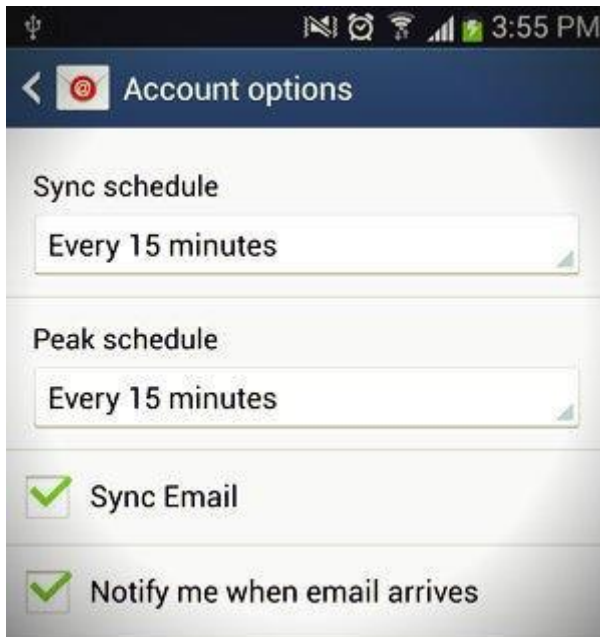

9. On the **Set up email** screen, customize the email account and sender names. Tap **Done** to complete the whole process.

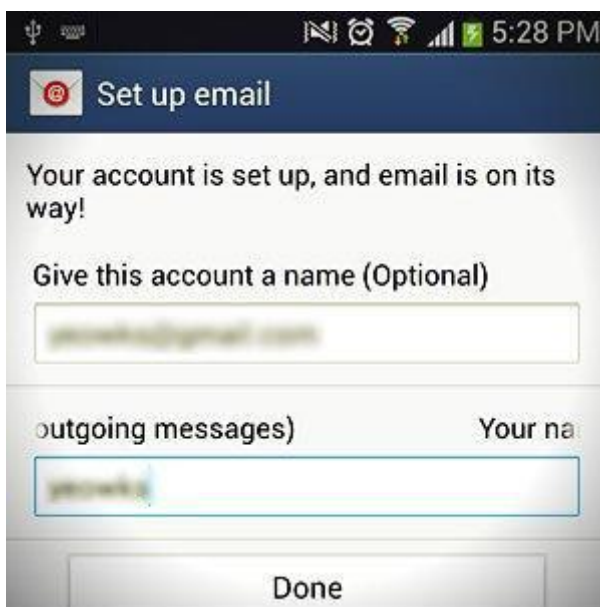

Setup 3rd Party Mail (POP) account - Samsung Galaxy S III

1. Tap Applications



2. Tap **Email**



3. If there are existing accounts:

- o Tap the **Options** key



o Tap **Settings**

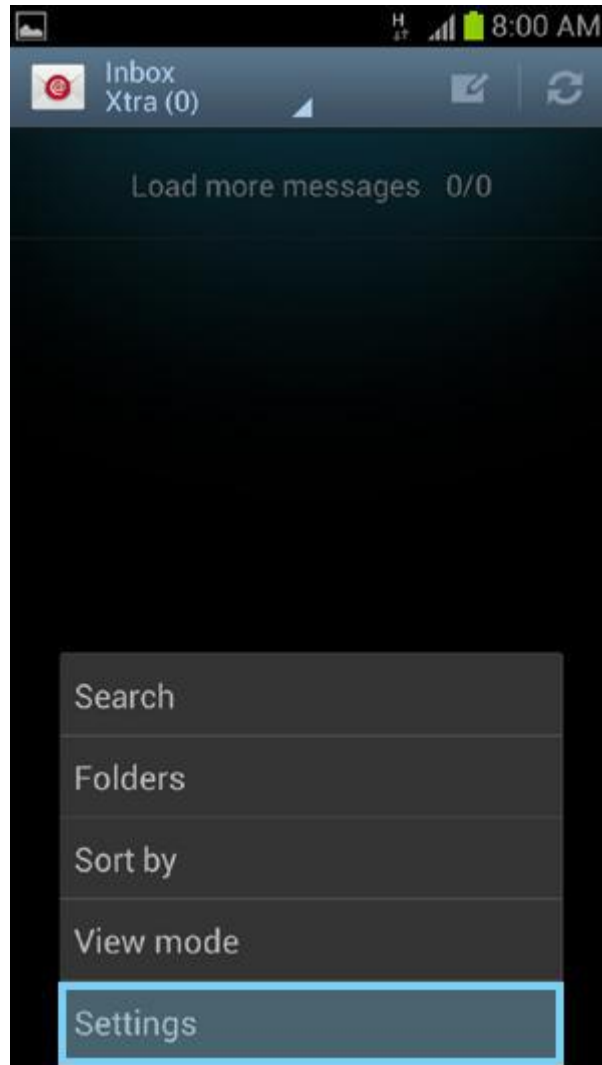

- o Tap the + icon

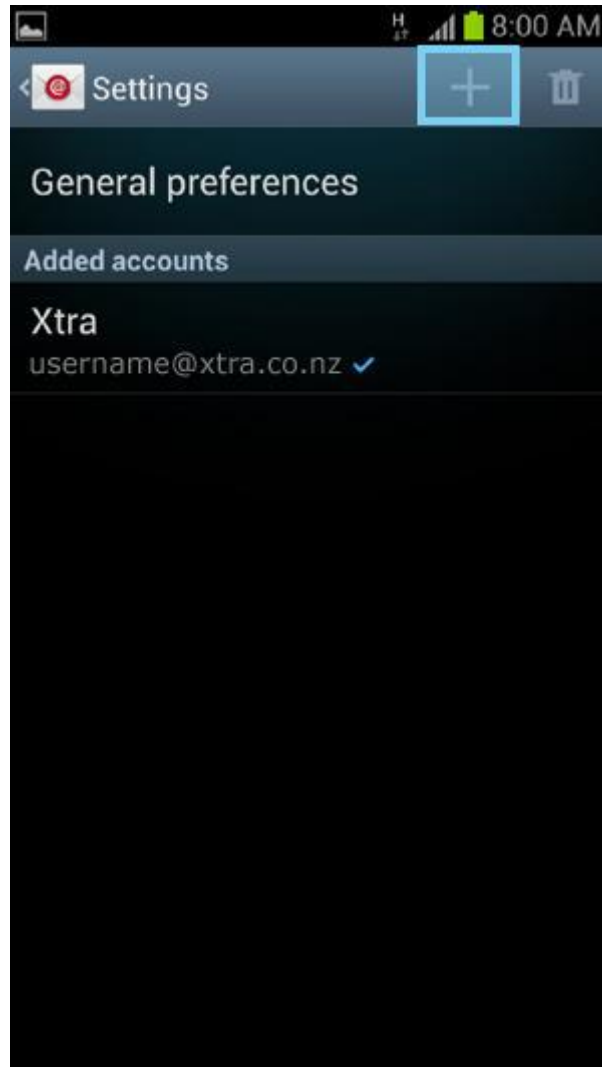

4. Tap the **Email Address** field
5. Enter your email address
6. Tap the **Password** field
7. Enter in your password

8. Tap **Manual Setup**

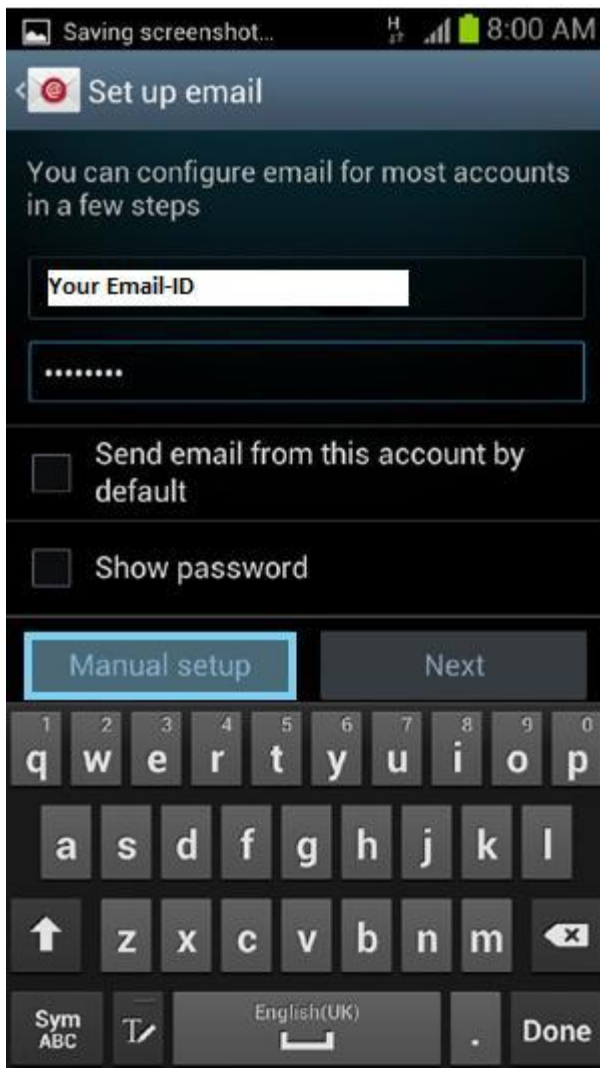

9. Tap POP3 Account

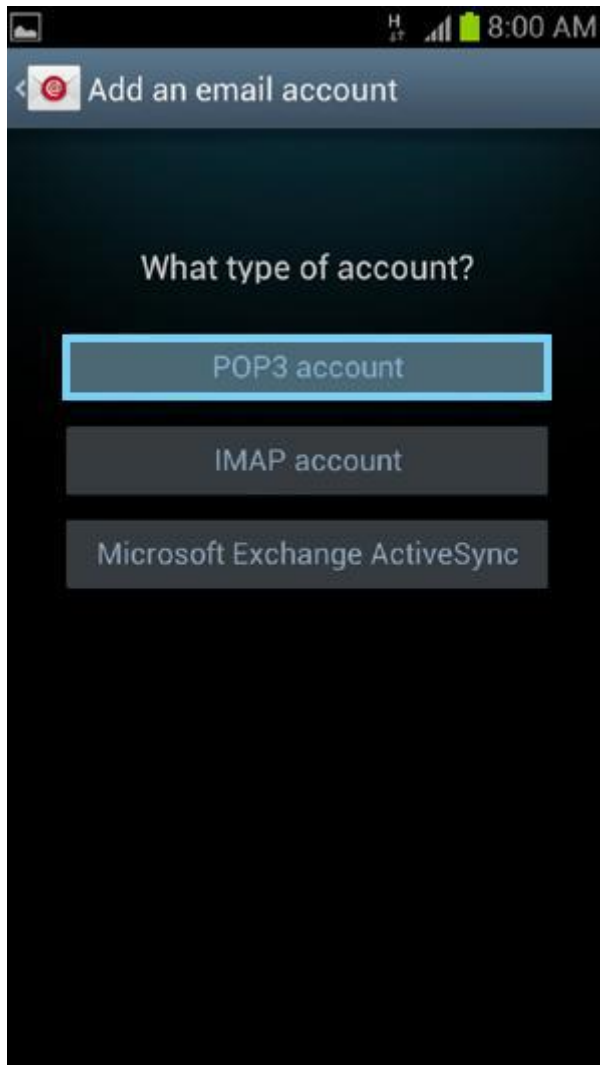

10. Enter in the incoming POP3 server address
11. Tap the **Security Type** field
12. Select the desired security type (i.e. **SSL**)
13. Tap the **Port** field
14. Enter in the port number
15. Tap in the **Delete Email form Server** field
16. Select **Never** or **When I Delete from Inbox**
17. Tap **Next**



Incoming server settings

Username
Your Email-Id

Password
.....

POP3 server
mx.w3i.email

Security type
SSL

Port
995

Delete email from server
Never

Next

23. Tap the **SMTP Server** field
24. Enter in the outgoing SMTP server address is **mx.w3i.email**
25. Tap the **Security Type** field
26. Select the desired security type (i.e. **SSL**)
27. Tap the **Port** field
28. Enter in the port number
29. Ensure **Require Sign In** is ticked
30. Tap the **Username** field
31. Enter in your username
32. Tap the **Password** field
33. Enter in your password
34. Tap **Next**



Outgoing server settings

SMTP server
mx.w3i.email

Security type
SSL

Port
465

Require sign-in

User name
Your email-id

Password

Next

35. Tap the **Email Check Frequency** field
36. Select the desired time
37. Tap **Next**

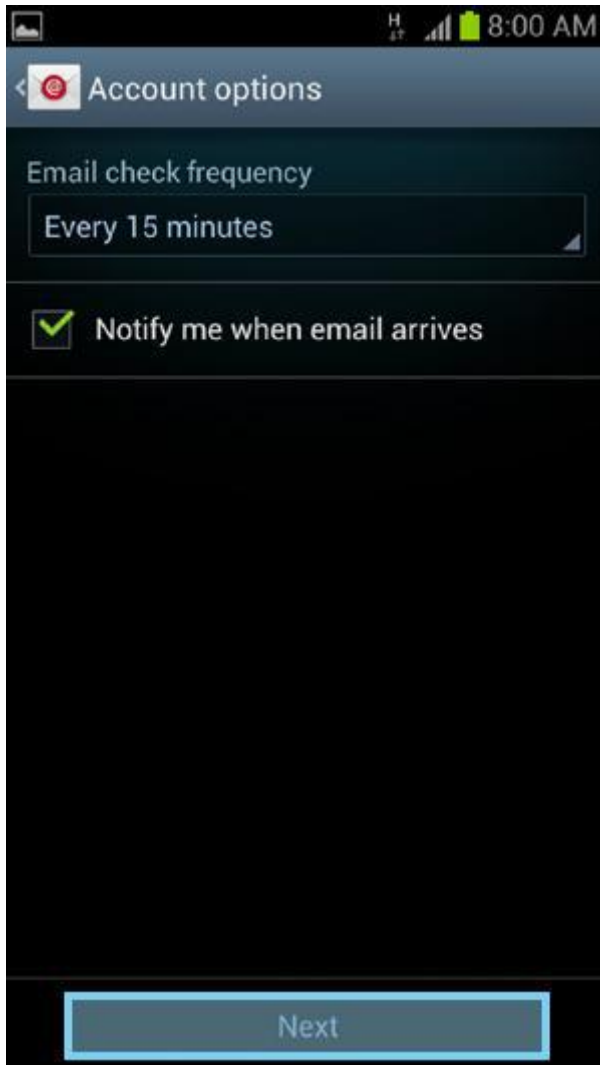

38. Tap the **Give this Account a Name** field
39. Enter in the name of the email provider
40. Tap the **Your Name** field
41. Enter in your full name
42. Tap **Done**

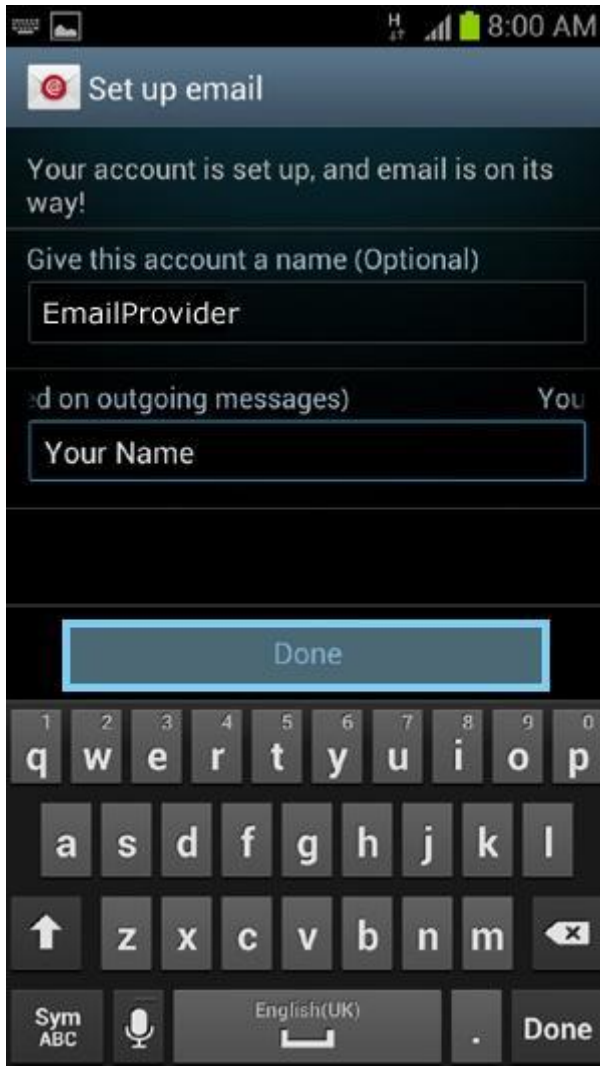

Webmail Link

<http://webmail.mxa.w3i.email/login.php>